

PARK CENTRAL HOTEL NEW YORK

GRAND BALLROOM

floorplan



GRAND BALLROOM (BALLROOM & FORUM)

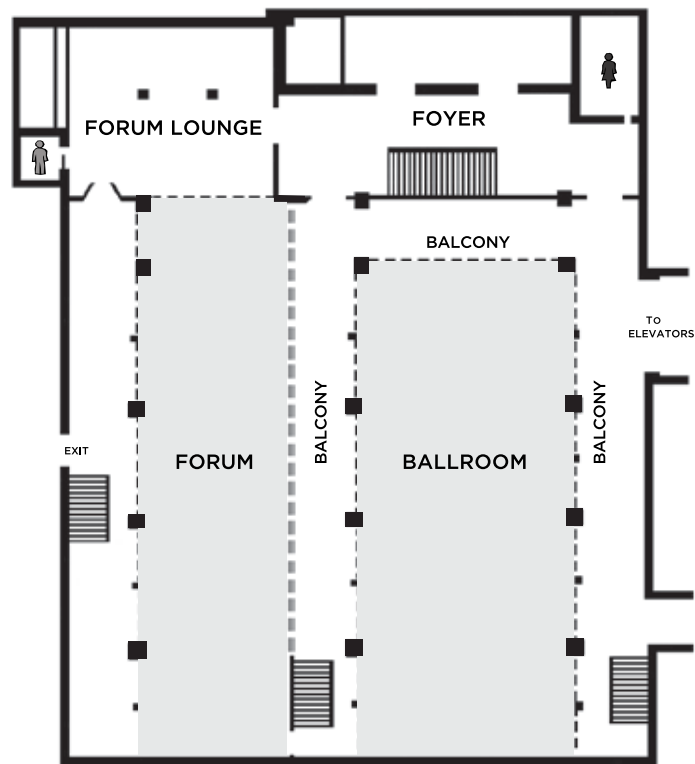

PARK CENTRAL HOTEL NEW YORK

BALLROOM SPECS

	SQ.FEET	DIMENSIONS	CEILING HEIGHT
BALLROOM	5170	92'9" x 52'4"	14'
BALLROOM w. BALCONY	—	—	—
FORUM	3348	92'9" x 52'4"	11'5"
GRAND BALLROOM (Ballroom & FORUM)	8518	92'9" x 88'1"	—

EVENT SPACE CAPACITY

	U-SHAPE (OUTSIDE ONLY)	THEATER STYLE	CLASSROOM STYLE	ROUND TABLES	DINNER & DANCE	COCKTAIL
BALLROOM	60	450	300	400	250	500
BALLROOM w. BALCONY	—	—	—	—	—	700
FORUM	50	250	180	300	170	350
GRAND BALLROOM (Ballroom & FORUM)	—	650	430	700	450	1000